

PLAN

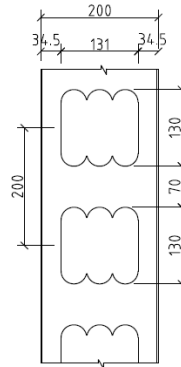

ELEVATION

200mm Profile Panel

The 200mm panel can be installed vertically to act as the main form for the wall or horizontally for beam applications.

Panels can be provided with clear or white faces.

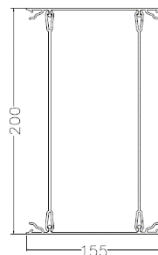
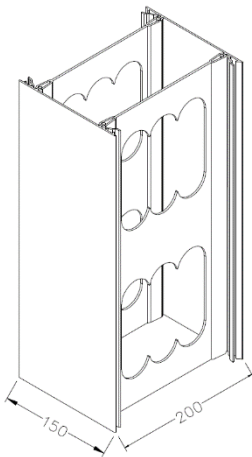

PLAN

PS-200 Panel Spacer

The Panel Spacer is installed in a vertical direction. Used as a 150mm spacer within the main form and is clipped into the male anchors on both ends.

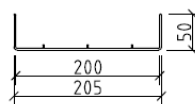
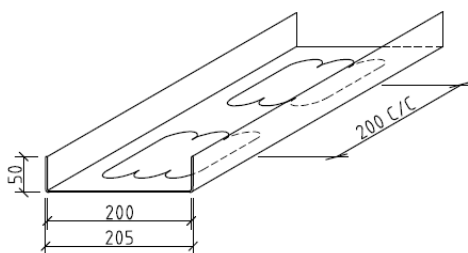

PLAN

BT-200 Bottom Track

The Bottom Track is installed in a horizontal direction and is used as a guide for the bottom of the wall to keep the panels into alignment.

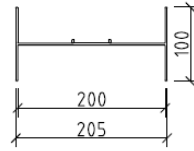
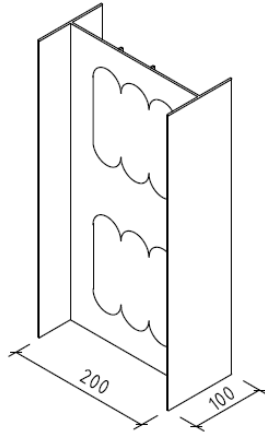

PLAN

PC-200 Panel Connector

The Panel Connector can be used both vertically and horizontally when joining the panels where no anchors are available. Use screws to fasten.

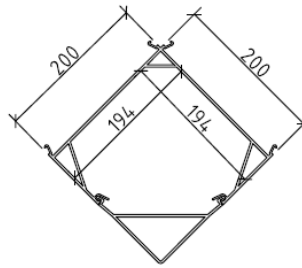
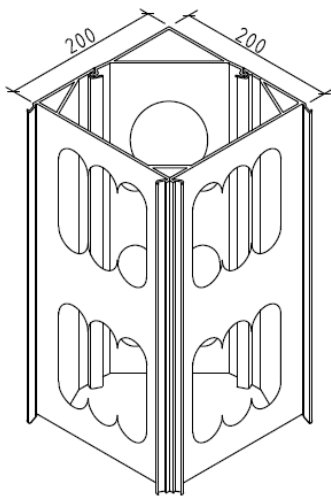

PLAN

CP-200 Corner Piece

The Corner Piece is installed vertically and is clipped into the Profile Panel to create a 90-degree corner.

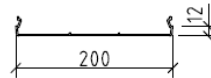
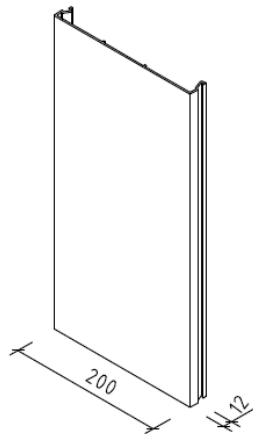

PLAN

ECM-200 End Cap Male

The Male End Cap is installed in a vertical direction. Used to cap off the end of the panel and is clipped into the female anchor.

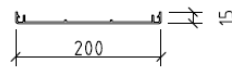
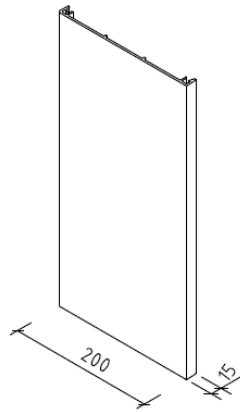

PLAN

ECF-200 End Cap Female

The Female End Cap is installed in a vertical direction. Used to cap off the end of the panel and is clipped into the male anchor.

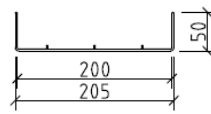
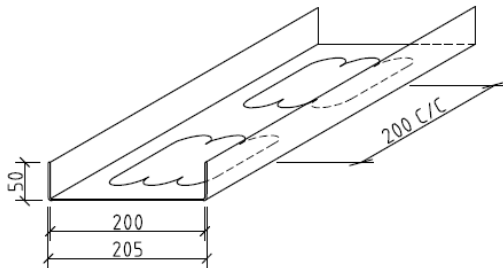

PLAN

BT-200 Bottom Track

The Bottom Track is installed in a horizontal direction and is used as a guide for the bottom of the wall to keep the panels into alignment.

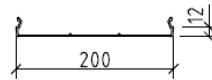
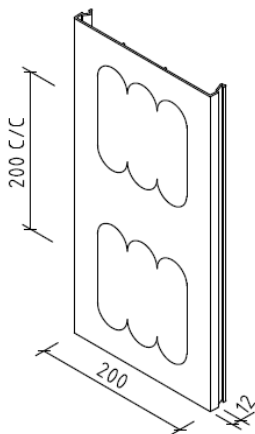

PLAN

JT-200 Junction Track

The Junction Track is installed in a vertical direction at wall intersections to create a T-Junction or corner off the main form.

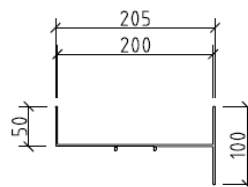
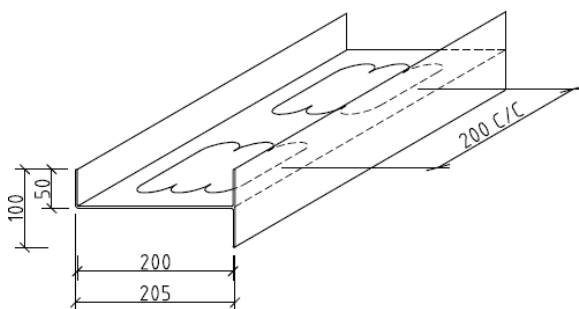

PLAN

EF-200 Edge Flashing

The Edge Flashing is used similarly as the Bottom Track on perimeter applications. Commonly used for perimeter walls, lift shafts and stairwells whereby the double flanged side is designed to cover the cold joint where the wall meets the concrete slab.